

Replaceable Clutch Stop

Subject: Replacement of welded-in pin style clutch stop.

Units Affected: WSES, RH, WSE

Situation: If the stop breaks, it is difficult to weld in a new piece accurately.

The Fix: Removal of the remaining pin and bolting in a new stop (95410014) using the front engine mount location.

Claim Procedure: None, part will be available at "No Charge".

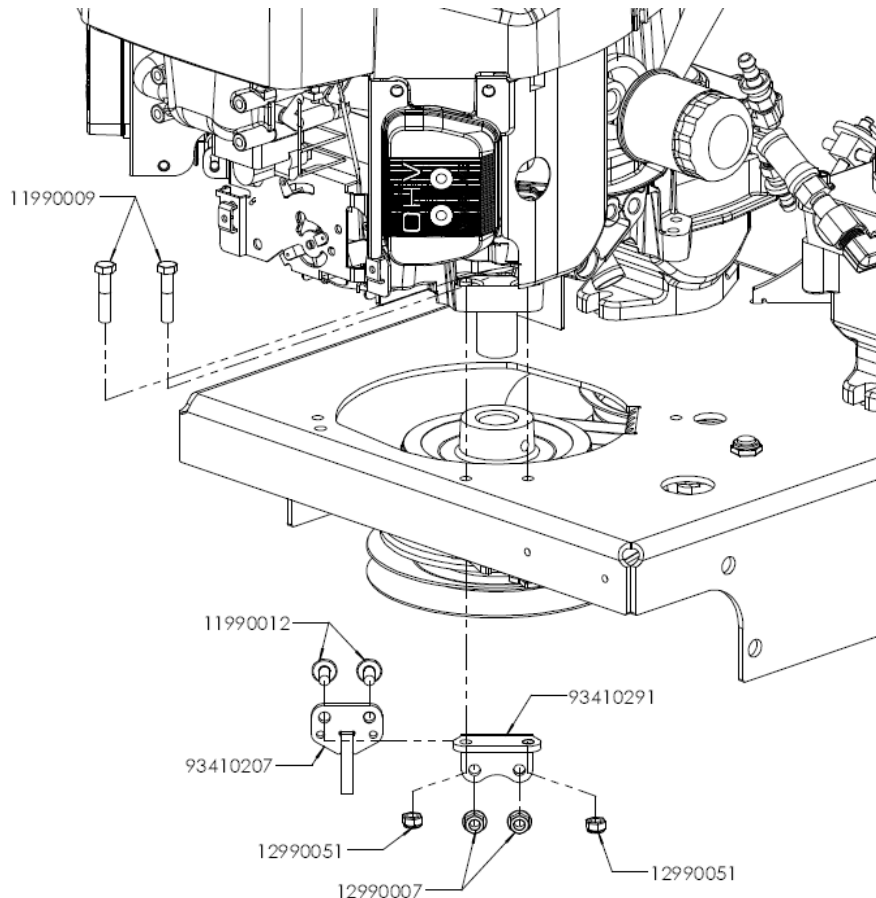

- 1) Cut off remaining clutch stop pin but leave the engine deck structure in place to use as the wire tie location for the clutch wire.
- 2) The bolt in stop will use the front engine mounting holes, remove the original engine mounting bolt and bolt in the stop bracket using the new hardware and existing mounting holes.
- 3) The position of the stop is critical per the model being fixed. On Sentar's the flush side of the stop must face the engine shaft. On WSES/RH's the flush side of the stop must face away from the engine shaft. Slightly move the clutch to line up with the stop and bolt the stop to the stop bracket.
- 4) Once the new stop is in place, if a hydro belt has to be replaced the stop will need to be removed.

